

T 19S, R 12E, M W

A	*	*	*	4	5	6	7	8	9	10	11	12	13	14	15	16	17	18	19	20	21	22	23	24	25
B	+	+	+	+	+	+	+	+	+	+	+	+	+	+	+	+	+	+	+	+	+	+	+	+	+
C	+	6	+	+	5	+	+	4	+	+	3	+	+	2	+	*	+	1	+	+	+	+	+	+	+
D	+	+	+	+	+	+	+	+	+	+	+	+	+	+	+	+	+	+	+	+	+	+	+	+	+
E	⊙	+	+	+	+	+	+	+	+	+	+	+	+	+	+	+	+	+	+	+	+	+	+	+	+
F	+	+	+	+	+	+	+	+	+	+	+	+	+	+	+	+	+	+	+	+	+	+	+	+	+
G	+	7	+	+	8	+	+	9	+	+	10	+	+	⊙	+	11	+	+	12	+	+	+	+	+	+
H	+	+	+	+	+	+	+	+	+	+	+	+	+	+	+	+	+	+	+	+	+	+	+	+	+
J	+	+	+	+	+	+	+	+	+	+	+	+	+	+	+	+	+	+	+	+	+	+	+	+	+
K	+	+	+	+	+	+	+	+	+	+	+	+	+	+	+	+	⊙	+	+	+	+	+	+	+	+
L	+	18	+	+	17	+	+	16	+	+	15	+	+	14	+	+	+	+	13	+	+	+	+	+	+
M	+	+	+	+	+	+	+	+	+	+	+	+	+	+	+	+	+	+	+	+	+	+	+	+	+
N	⊙	+	+	*	+	+	+	+	+	+	+	⊙	+	+	+	+	⊙	+	+	+	+	+	+	+	+
O	+	+	+	+	+	+	+	+	+	+	+	+	+	+	+	+	+	+	+	+	+	+	+	+	+
P	+	19	+	+	20	+	+	⊙	+	21	+	+	22	+	+	23	+	+	24	+	+	+	+	+	+
Q	+	+	+	+	+	+	+	+	+	+	+	+	+	+	+	+	+	+	+	+	+	+	+	+	+
R	*	+	+	+	+	+	+	+	⊙	+	+	+	+	+	+	+	+	+	+	+	+	+	+	+	+
S	+	+	+	+	+	+	+	+	+	+	+	+	+	+	+	+	+	+	+	+	+	+	+	+	+
T	+	30	+	+	29	+	+	⊙	+	28	+	+	27	+	+	26	+	+	25	+	+	+	+	+	+
U	+	+	+	+	+	+	+	+	+	+	+	+	+	+	+	+	+	+	+	+	+	+	+	+	+
V	+	+	+	+	+	+	+	+	+	+	+	+	+	+	+	+	+	+	+	+	+	+	+	+	+
W	+	+	+	+	+	+	+	+	+	+	+	+	+	+	+	+	+	+	+	+	+	+	+	+	+
X	+	31	+	+	32	+	+	33	+	+	34	+	+	35	+	+	36	+	+	+	+	+	+	+	+
Y	+	+	+	+	+	+	+	+	+	+	+	+	+	+	+	+	+	+	+	+	+	+	+	+	+
Z	+	+	+	+	+	+	+	+	+	+	+	+	+	+	+	+	+	+	+	+	+	+	+	+	+

LEGEND

⊙ = Corner having information on form 7100-52 in this file.

Ledgend conforms to Reporting Forms MB '79

JE-10-79 11/79 mpmcc

FILING INSTRUCTION

File 7100-52 card record by letter and number coordinates behind the file guide for the township in which it falls.

File the 7100-52 card record by letter and then by number i.e., all A cards first, then B cards etc.

The first card behind the file guide (if data have been obtained and recorded) will be card A-1 for N.W. Township Corner, then card A-2 for 1/16 corner then card A-3 for 1/4 corner etc.

LAND CORNER RECORD

A-1 5680-2

1. T 19 S R 12 E No. A-1 Cor. Sec Mer Will State Oregon (Rectangular) N. F. Deschutes Dist. Fort Rock

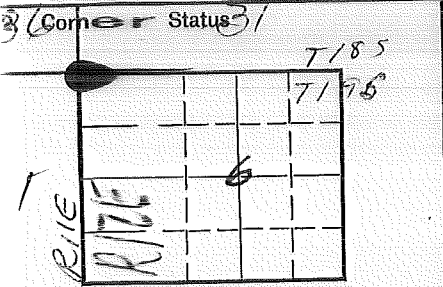

3. Original Description _____ Vol. _____ Page _____ Where Recorded _____

4. Description of Corners:
RC

5. Investigation Notes:
Sec E-25 T18S R11E Wm.

7. Photo Identification

Photo No. _____
Ident. By: _____

8. Plane Coordinate Position Data

State _____ Zone _____
X _____
Y _____
Estab. By _____
Field Book No. _____
Where Filed _____

9. Evaluation

Authentic X
Needs Verif. _____ Monument Yes
Re-estab. _____ Survey _____
Land Status _____

6. Signed _____ Title _____ Date _____

Index File No.	CORNER RECORD (SEARCH) (Ref. FSM 7151.4)			Tract or Survey No.	Cor. No.
19	S. R. 12	E.	R.D. Font Rock	County Deschutes	A-2
Merid. WILLAMETTE	N.F. DESCHUTES	State	OREGON		

See Z 2 T 185 R 12 E

steel set by
Century west.

Index
File No. _____
T 19S R. 12E
Merid. WILL.

CORNER RECORD (SEARCH)
(Ref. FSM 7151.4)
R.D. FORT ROCK County DESCHUTES
N.F. DESCHUTES State OREGON

Tract or
Survey No. _____
Cor.
No. A-3

CORNER DIAGRAM

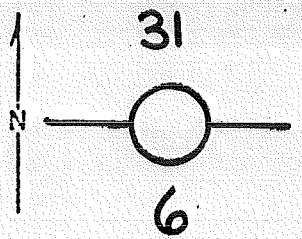

DESCRIBE CORNER MONUMENT FOUND

SEE T 18S R 12E
Z-3

DESCRIBE BEARING TREES OR OTHER OFFICIAL ACCESSORIES FOUND

SFNF

PHOTO IDENTIFICATION DATA

Photo No. _____
Filed At. _____
Object Ident. _____
Ident. By _____
Signature

DESCRIBE CORNER LOCATION RELATIVE TO NEAR-BY FEATURES, ALSO HOW TO REACH CORNER

PLANE COORDINATE POSITION DATA

State _____ Zone _____
X _____
Y _____
Estab. By _____
Agency

Signature _____ Title _____ Division _____ Headquarters _____ Date _____

Index
File No. _____
T 19 S. R. 12 E. R.D. _____ County DESCHUTES
Merid. WILLAMETTE N.F. DESCHUTES State OREGON Cor. No. A-5

SEE T 18S R 12E

Z-5

BC.

Index

File No. 0125 2551

CORNER RECORD (SEARCH)

(Ref. FSM 7151.4)

Contract or

Survey No.

000807

Cor. No.

A-25

T 19 S. R. 12 E. R.D.

Ft Rock

County

Deschutes

NE

Cor. of

Merid. WILLAMETTE N.F.

DESCHUTES

State

OREGON

Section

1

SEE: Z-01 T. 18 S., R. 13 E., W.M.

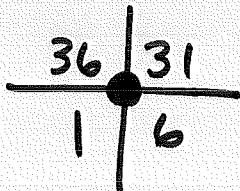

2 1/2" ACAP

Index File No. C-21

CORNER RECORD (SEARCH)

(Ref. FSM 7151.4)

T 19S R. 12E

R.D. Fort Rock

County

Deschutes

Tract or Survey No. _____

Cor. No. C.21
W/4 Cor. S.1

Merid. Willamette

N.F. Deschutes

State

Oregon

CORNER DIAGRAM

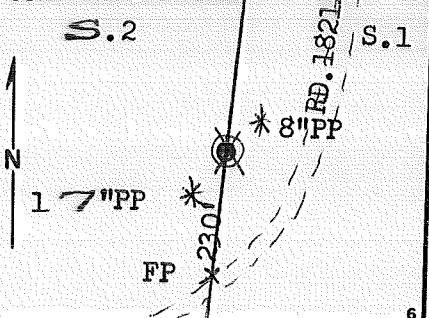

DESCRIBE CORNER MONUMENT FOUND

N O T H I N G

DESCRIBE BEARING TREES OR OTHER OFFICIAL ACCESSORIES FOUND

Two rotting stumps w/ "BT" scribes

PHOTO IDENTIFICATION DATA

Photo No. _____

Filed At. _____

Object Ident. _____

Ident. By _____

Signature _____

PLANE COORDINATE POSITION DATA

State _____ Zone _____

X _____

Y _____

Estab. By _____

Agency _____

Signature _____

Title

PLS

Division

Headquarters

DNF-SO

Date

20 AUG 1976

7100-52-(3/68)

4

5

CORNER RECORD (PERPETUATION)

MONUMENT: DESCRIBE NEW MONUMENT SET, OR WORK DONE TO PRESERVE EXISTING MONUMENT

Set 5/8" x 30" Steel Rod, rising 5", center punched and stamped "A",
in mound of stones.

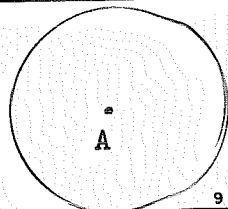

9

ACCESSORIES : DESCRIBE NEW BT'S WITNESS OBJECTS ETC. ESTABLISHED, OR WORK DONE TO PRESERVE EXISTING EVIDENCE

An 8" Ponderosa Pine bears N73°E 58.45 feet, B&S "1/4 S1 BT", nail in W side;
A 17" Ponderosa Pine bears S28°W 46.88 feet, B&S " 1/4 S2 BT", nail in E. side.

10

Work Done By R. Oman Title PLS Date 5/76 State Registration OR-702 or Agency WV-23
Certified Cor. Record Prepared ? Yes No Filed At: Deschutes Co. Surveyor's Office Date 6/76

11

REMARKS

Index File No. T. 19S R. 12 E.W. M. Tract or Surv. No. Cor. C-21

12

13

E-01

Section Line Marker Record

Old Highway #97 Road or Trail Fort Rock District

Sec. Line between 6 & 7 T. 19 S. R. 12 E.

Sec. Cor. 11 ch. Ft. W
¼ or Sec. feet N. S. E. or W.

Posted on W- side R
N. S. E. or W. R. or T.

~~Posted~~ Replaced 1/19/59 By M.L.C.
Date

(Approx. _____)

Cor. Found (Exact. X)

(Paced X)

Distance (Chained _____)

6	5	4	3	2	1
X 7	8	9	10	11	12
18	17	16	15	14	13
19	20	21	22	23	24
30	29	28	27	26	25
31	32	33	34	35	36

Indicate position of marker by red X

If marker is on Twp. or Rge. line, reference TWP. NORTH or Rge. EAST of that line.

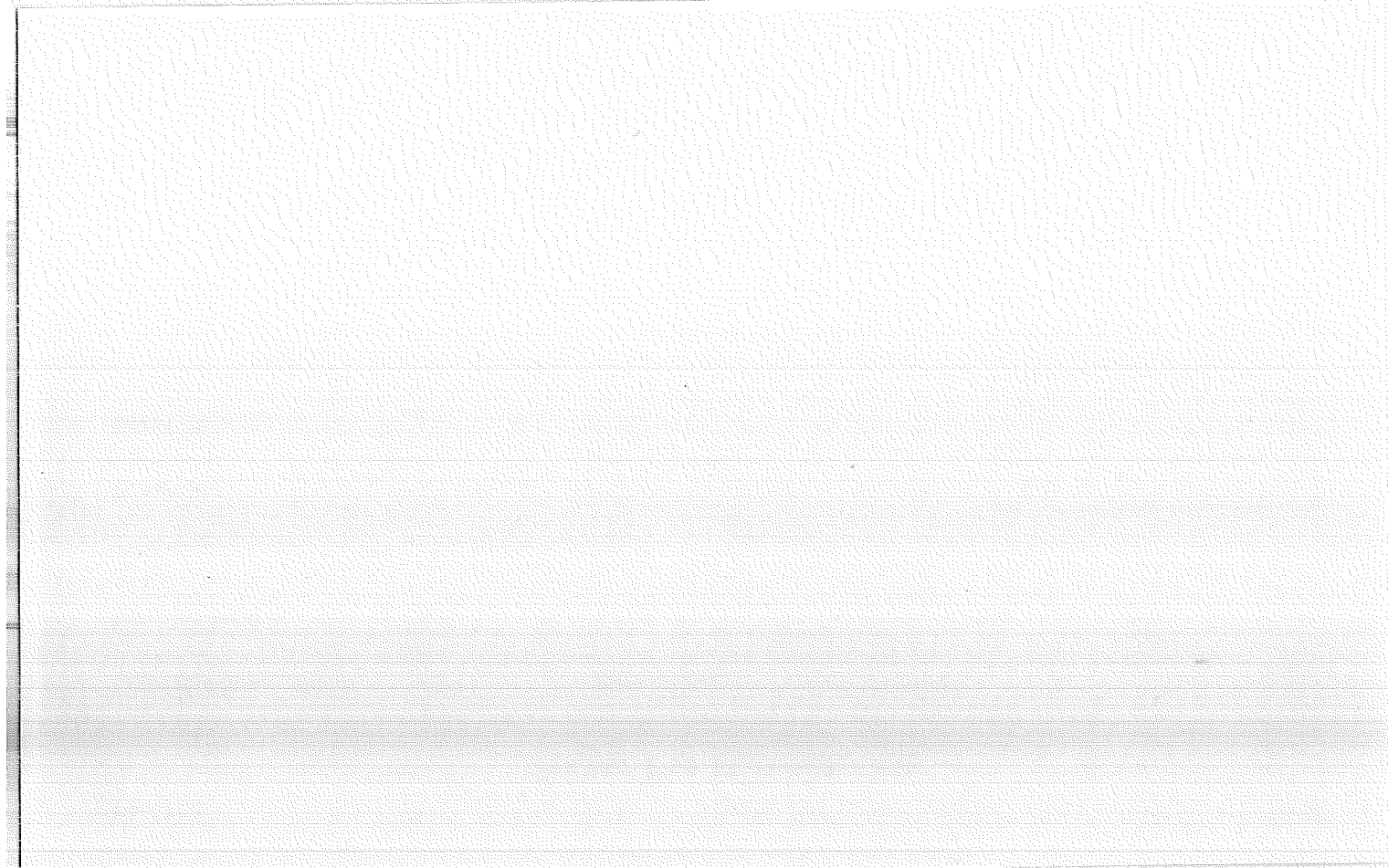

Index
File No. E-21

CORNER RECORD (SEARCH)

(Ref. FSM 7151.4)

Tract or

Survey No. _____

Cor. No. E-21

T 19S R. 12E

R.D. Fort Rock County _____

Deschutes

SW Cor. S.1

Merid. Willamette

N.F. Deschutes State _____

Oregon

CORNER DIAGRAM 1821

S. 2 S. 1

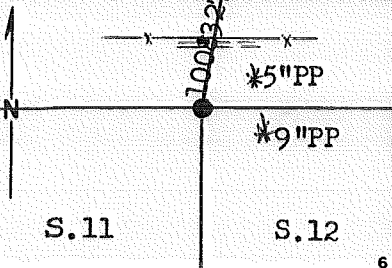

DESCRIBE CORNER MONUMENT FOUND

N O T H I N G

In old clear cut area, plowed for tree planting.

DESCRIBE BEARING TREES OR OTHER OFFICIAL ACCESSORIES FOUND

Three pine stumps, sawn, w/ "BT" scribes

PHOTO IDENTIFICATION DATA

Photo No. _____

Filed At. _____

Object Ident. _____

Ident. By _____

Signature

DESCRIBE CORNER LOCATION RELATIVE TO NEAR-BY FEATURES, ALSO HOW TO REACH CORNER

PLANE COORDINATE POSITION DATA

State _____ Zone _____

X _____

Y _____

Estab. By _____

Agency

Signature

Title
PLS

Division

Headquarters
DNF-SO

Date 20 AUG 1976

7100-52-(3/68)

CORNER RECORD (PERPETUATION)

MONUMENT : DESCRIBE NEW MONUMENT SET, OR WORK DONE TO PRESERVE EXISTING MONUMENT

Set 2" x 20" Brass-Capped Steel Pipe, rising 6" in mound of stones, stamped as shown:

T19S R12E
2.1
11|12

9

ACCESSORIES : DESCRIBE NEW B^Y's WITNESS OBJECTS ETC. ESTABLISHED, OR WORK DONE TO PRESERVE EXISTING EVIDENCE

A 5" Ponderosa Pine bears N46^OE 52.4 feet, B&S "S1 Cor BT";

A 9" Ponderosa Pine bears S88^OE 75.6 feet, B&S "S12 BT".

10

Work Done By R. Oman Title PLS Date 5/76 State Registration No. OR-702 WV-23
or Agency
Certified Cor. Record Prepared? Yes No Filed At: Desch. Co. Surveyor's Office Date 6/76

11

REMARKS

12

Index File No.

T. 19S R. 12 E.W. M.

Tract or Surv. No.

Cor. E-21

13

Index
File No. F-23

CORNER RECORD (SEARCH)

(Ref. FSM 7151.4)

Tract or Survey No. _____
Cor. E-23 No. _____

T 19 S R. 12 E

R.D. Fort Rock County Deschutes

S/4 Cor. S.1

Merid. Willamette

N.F. Deschutes State Oregon

CORNER DIAGRAM

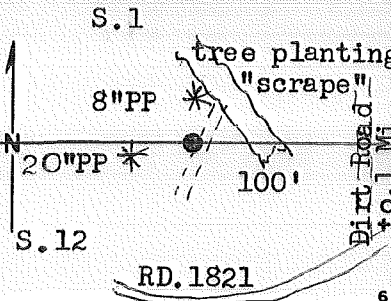

DESCRIBE CORNER MONUMENT FOUND

Cor. Tree (Now log w/stump attached) apparently ripped out for now-abandoned road.

DESCRIBE BEARING TREES OR OTHER OFFICIAL ACCESSORIES FOUND

S.12--Rotted, sawn stump w/ "BT" scribe.

S.1-- BT Torn out for tree planting.

PHOTO IDENTIFICATION DATA

Photo No. _____
Filed At. _____
Object Ident. _____
Ident. By _____
Signature

DESCRIBE CORNER LOCATION RELATIVE TO NEAR-BY FEATURES, ALSO HOW TO REACH CORNER

PLANE COORDINATE POSITION DATA

State _____ Zone _____
X _____
Y _____
Estab. By _____
Agency

Signature
Title PLS

Division _____

Headquarters _____

DNF-S0

Date _____

20 AUG 1976

7100-52-(3/68)

CORNER RECORD (PERPETUATION)

MONUMENT: DESCRIBE NEW MONUMENT SET, OR WORK DONE TO PRESERVE EXISTING MONUMENT

Set 2" x 32" Brass-Capped Steel Pipe, rising 7" in a mound of stones, about 100 feet west of a dirt road and about 500 feet north of Rd. 1821, stamped as shown:

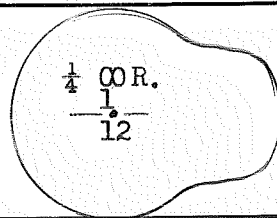

ACCESSORIES: DESCRIBE NEW BT'S WITNESS OBJECTS ETC. ESTABLISHED, OR WORK DONE TO PRESERVE EXISTING EVIDENCE

A 20" Ponderosa Pine bears S72°W 38.33 feet, B&S "S12 BT", w/nail in N. side;

An 8" Forked Ponderosa Pine bears N02°E 93.21 feet, B&S "1/4 S1 BT", w/nail in E. side.

Work Done By. R. Oman Title PLS Date 5/76 State Registration No. OR-702 WV-23
 or Agency
 Certified Cor. Record Prepared? Yes No Filed At: Des. Co. Surveyor's Office Date 6/76

REMARKS

Index File No.

T. 19S

R. 12E. W. M.

Tract or Surv. No.

Cor. E-23

Index
File No. E-25

CORNER RECORD (SEARCH)

(Ref. FSM 7151.4)

Tract or
Survey No. _____
Cor. No. E-25

T 19S R. 12E R.D. Fort Rock County Deschutes SE Cor. S.1
Merid. Willamette N.F. Deschutes State Oregon

CORNER DIAGRAM

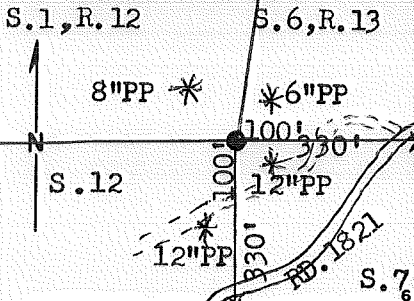

DESCRIBE CORNER MONUMENT FOUND

Nothing

DESCRIBE BEARING TREES OR OTHER OFFICIAL ACCESSORIES FOUND

All rotted, sawn stumps w/ "BT" scribes.

PHOTO IDENTIFICATION DATA

Photo No. _____
Filed At. _____
Object Ident. _____
Ident. By _____
Signature

DESCRIBE CORNER LOCATION RELATIVE TO NEAR-BY FEATURES, ALSO HOW TO REACH CORNER

PLANE COORDINATE POSITION DATA

State _____ Zone _____
X _____
Y _____
Estab. By _____
Agency

Signature

Title
PLS

Division

Headquarters
DNF-SQ

Date
20 AUG 1976

7100-52-(3/68)

CORNER RECORD (PERPETUATION)

MONUMENT : DESCRIBE NEW MONUMENT SET, OR WORK DONE TO PRESERVE EXISTING MONUMENT

Set 2" x 32" Brass-Capped Steel Pipe, rising 5" in a mound of stones,
stamped as shown:

T19S
 R12E | R13E
 1.6
 12 | 7

ACCESSORIES : DESCRIBE NEW BT'S WITNESS OBJECTS ETC. ESTABLISHED, OR WORK DONE TO PRESERVE EXISTING EVIDENCE

A 6" Ponderosa Pine bears N30°E 72.2 feet, B&S "S6 R13E BT";
 A 12" Ponderosa Pine bears S86°E 69.5 feet, B&S "S7 R13E BT";
 A 12" Ponderosa Pine bears S28°W 118.0 feet, B&S "S12 R12E BT";
 A 8" Ponderosa Pine bears N50°W 105.3 feet, B&S S1 R12E BT".

Work Done By R. Oman Title PLS Date 5/76 State Registration or Agency OR-702 WV-23
 Certified Cor. Record Prepared? Yes No Filed At: Des. Co. Surveyor's Office Date 6/76

REMARKS

Index File No.

T. 19S R. 12 E. W.M.

Tract or Surv. No.

Cor. E-25

10

11

12

13

Section Line Marker Record

1924 1/4 S. Bessie Butte Road or Trail Fort Rock District

Sec. Line between 10 & 11 T. 19 S. R. 12 E. _____

1/4 Cor. 300 Ft. S
 1/4 or Sec. feet N. S. E. or W.

Posted on S side Road
 N. S. E. or W. R. or T.

Posted 1933 By Brown & Miller
 Date

(Approx. _____)

Cor. Found (Exact. _____)

(Paced _____)

Distance (Chained _____)

6	5	4	3	2	1
7	8	9	10	^X 11	12
18	17	16	15	14	13
19	20	21	22	23	24
30	29	28	27	26	25
31	32	33	34	35	36

Indicate position of marker by
 red X

If marker is on Twp. or Rge. line, reference TWP. NORTH or Rge. EAST of that line.



USDA-FOREST SERVICE

Index

File No. _____

CORNER RECORD (SEARCH)

(Ref. FSM 7151.4)

Tract or

Survey No. _____

Cor.

No. J-17

T 19S R. 12E

R.D. Bend County Deschutes

NW Cor S 14

Merid. Will.

N.F. Deschutes State OR

CORNER DIAGRAM

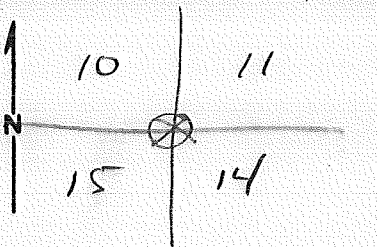

DESCRIBE CORNER MONUMENT FOUND

SFNF From found BTs, set nail at the point that best fit the Bearings & Distances.
Tied corner to 1992 survey of LunaBess P.T. 2

DESCRIBE BEARING TREES OR OTHER OFFICIAL ACCESSORIES FOUND

FD 4 BTs
20" P Pine stump N62°W 30.3' (46 LKS) Scribing Visible
26" P Pine " S55°E 55.6' (84 LKS) burnt over
24" P Pine " S43°E 56.2' (85 LKS) Scribing Visible
36" P Pine " N50°W 11.2' "17 LKS" " " 3

PHOTO IDENTIFICATION DATA

Photo No. _____
Filed At. _____
Object Ident. _____
Ident. By _____
Signature 7

DESCRIBE CORNER LOCATION RELATIVE TO NEAR-BY FEATURES, ALSO HOW TO REACH CORNER

From location tag on E side of RD 036 go 660' East to corner
Found old cruiser post in mound of stone S38°E 6.7 ft. Its location does not fit the R.Ts. NE BT had an old loc. tag on it. 4

PLANE COORDINATE POSITION DATA

State _____ Zone _____
X _____
Y _____
Estab. By _____
Agency 8

Signature S. Keith Title Survey Tech. Division CS Headquarters SO Date 7/12/92 FS-7100-52 (3/68) 5

CORNER RECORD (PERPETUATION)

MONUMENT: DESCRIBE NEW MONUMENT SET, OR WORK DONE TO PRESERVE EXISTING MONUMENT

Set 10" spike at position determined from B T's

21" PPine N46°W 12.2 FT, nail in East base w/ location post

16" " S 85°E 32.3 FT, nail in North base " " "

metal post 3' North w/ location tag

ACCESSORIES : DESCRIBE NEW B T's WITNESS OBJECTS ETC. ESTABLISHED, OR WORK DONE TO PRESERVE EXISTING EVIDENCE

Work Done By William Title LS Date 7/16/92 State Registration No. 2396
 or Agency

Certified Cor. Record Prepared? Yes No Filed At:

Date

Survey of 1880.

REMARKS

Set post for corner to Secs. 10, 11, 14 & 15, from which:

A Pine 20 in diam bears N 59° W 79 Lks dist.

A " 30 " " " S 58° W 81 " "

A " 20 " " " S 45° E 86 " "

A " 30 " " " N 5° E 17 " "

Index File No.

T. 19 S R. 12 E M.

Tract or Surv. No.

Cor.

LAND CORNER RECORD

(Rectangular)

N-1

5680-2

1. T 19S R 12E No. N-1 Cor. Sec. Mer. Will State Oregon N. F. Deschutes Dist. Fort Rock

2. Corner Status

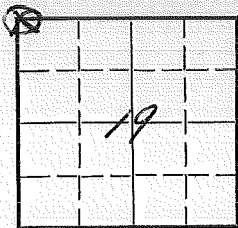

3. Original Description _____ Vol. _____ Page _____ Where Recorded _____

4. Description of Corners: _____

5. Investigation Notes:

See T19S R11E (N-25) Wm.

Loc. Marker 975' E & 677' E. of cor.

7. Photo Identification

Photo No. _____

Ident. By: _____

8. Plane Coordinate Position Data

State _____ Zone _____

X _____

Y _____

Estab. By _____

Field Book No. _____

Where Filed _____

9. Evaluation

Authentic _____

Needs Verif. _____ Monument _____

Re-estab. _____ Survey _____

Land Status _____

6. Signed _____ Title _____ Date _____

PERPETUATION RECORD

10. Monument:

11. Accessories

12. Set By _____ Title _____
License _____ Agency _____ Date _____

13. Recorded By _____ (Agency) _____
_____ (Date) _____ (City) _____ (County) _____ (State)
Field Book _____ Page _____
Volume _____ Page _____

14. Remarks:

Index
File No. N-5

CORNER RECORD (SEARCH)

(Ref. FSM 7151.4)

Tract or
Survey No. _____ Cor.
No. N-5T 19S R. 12ER.D. _____ County DeschutesMerid. WillN.F. Deschutes State Oregon

CORNER DIAGRAM

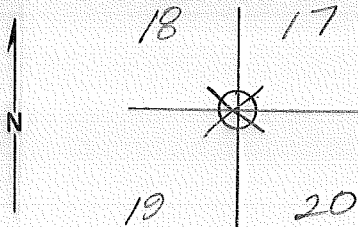

DESCRIBE CORNER MONUMENT FOUND

wood post 4'x3"x3", Laying on ground in poor condition
Sides of post scribed 18, 17, 20, 19

DESCRIBE BEARING TREES OR OTHER OFFICIAL ACCESSORIES FOUND

B.T. present, Area is well ribboned in Blue for
identification.

PHOTO IDENTIFICATION DATA

Photo No. _____

Filed At _____

Object Ident. _____

Ident. By _____

Signature

PLANE COORDINATE POSITION DATA

State _____ Zone _____

X _____

Y _____

Estab. By _____

Agency

DESCRIBE CORNER LOCATION RELATIVE TO NEAR-BY FEATURES, ALSO HOW TO REACH CORNER

Corner Reference on Rd. 2131

South on ?? to Rd 1942, go down 1942 1/4 Mi to Rd 1924
Turn East and go 2 Mi. to section Board, Corner is 214'
S. from Board 4/77 DR

Signature

Title

Division

Headquarters

Date

7100-52 (3/68)

D. Hicks

Supv. for Tech.

1-23-76

5

CORNER RECORD (PERPETUATION)

MONUMENT : DESCRIBE NEW MONUMENT SET, OR WORK DONE TO PRESERVE EXISTING MONUMENT

9

ACCESSORIES : DESCRIBE NEW BT's WITNESS OBJECTS ETC. ESTABLISHED, OR WORK DONE TO PRESERVE EXISTING EVIDENCE

10

Work Done By _____ Title _____ Date _____ State Registration No. or Agency _____

Certified Cor. Record Prepared ? Yes No Filed At: _____ Date _____

11

REMARKS

Index File No. T. R. M. Tract or Surv. No. Cor. *N-5*

12

13

1. T 19S R 12E No. N-13 Cor. Sec Mer. W State Oregon N.F. Deschutes Dist. Fort Rock

2. Corner Status

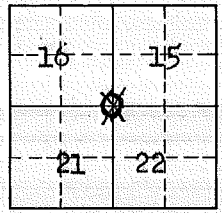

7. PHOTO IDENTIFICATION

Photo No. _____
Ident. By: _____

8. Plane Coordinate Position Data

State _____ Zone _____
X _____
Y _____
Est. By _____
Field Book No. _____
Where Filed _____

9. EVALUATION

Authentic _____
Needs Verif. _____ Manum. _____
Re-Est. _____ Survey _____
Land Status _____

3. Original Description _____ Vol. _____ Page _____ Where recorded _____

4. Description of Corner:

Old cruisers tag on 16" DBH PP tree.
No bearing trees or stumps.

5. Investigation Notes: 4-1-77 DR Forestry Tech.

Tree \rightarrow 16" dia. in good condition with tag 4ft. above the ground. and Blase

Corner marked by blazed tree with partially visible Metal section corner tag. Tree marked by orange paint and blue ribbon

Head South from Bend on Hwy 97, Turn left on Rd. 1942, go 1/4 mi. and turn East on Rd 1924, go 2 1/2 mi. turn NE on RD ~~1924~~ 1924 H, go 1/2 mi. to Fire Rd 2 turn NW (Left) and travel 80 yards to Section Boards Corner lies 419' south

6. Signed _____ Title _____ Date _____

LAND CORNER RECORD

(Rectangular)

562-2
N-17

1. T. 19S R. 12E No. N-19 Cor. $\frac{7}{4}$ Mer. ~~Wm.~~ State Oregon N. F. Deschutes Dist. Fort Rock

2. Corner Status

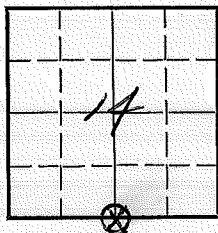

7. Photo Identification

Photo No. _____

Ident. By: _____

8. Plane Coordinate Position Data

State _____ Zone _____

X _____

Y _____

Estab. By _____

Field Book No. _____

Where Filed _____

9. Evaluation

Authentic _____

Needs Verif. Monument No. _____

Re-estab. Survey _____

Land Status F.S. _____

3. Original Description _____ Vol. _____ Page _____ Where Recorded _____

4. Description of Corners:

5. Investigation Notes: B.T. 16" Juniper scribed $\frac{1}{4}$ S

6. Signed K.H. Tiller Title _____ Date 6/22/60

Section Line Marker Record

#1924 Swamp Wells Road or Trail Fort Rock District

Sec. Line between 20 & 21 T. 19 S. R. 12 E.

Sec. Cor. 680 Ft. N
 1/4 or Sec. feet N. S. E. or W.

Posted on S side R
 N. S. E. or W. R. or T.

Replaced 5/3/54 By M. L. C.
 Date

(Approx. X

Cor. Found (Exact.

(Paced X

Distance (Chained

6	5	4	3	2	1
7	8	9	10	11	12
18	17	16	15	14	13
19	20	X 21	22	23	24
30	29	28	27	26	25
31	32	33	34	35	36

Indicate position of marker by red X

If marker is on Twp. or Rge. line, reference TWP. NORTH or Rge. EAST of that line.

LAND CORNER RECORD

R-1 5680-21. T 19S R 12E No. R-1 Cor. Sec Mer. Wm. State Oregon (Rectangular) N. F. Deschutes Dist. Fort Rock

2. Corner Status

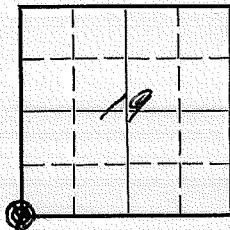

7. Photo Identification

Photo No. _____

Ident. By: _____

8. Plane Coordinate Position Data

State _____ Zone _____

X _____

Y _____

Estab. By _____

Field Book No. _____

Where Filed _____

9. Evaluation

Authentic _____

Needs Verif. _____ Monument _____

Re-estab. _____ Survey _____

Land Status _____

3. Original Description _____ Vol. _____ Page _____ Where Recorded _____

4. Description of Corners:

5. Investigation Notes: See R-25 T19S R11E Wm.

6. Signed _____ Title _____ Date _____

USDA-FOREST SERVICE

Index
File No. 0567

CORNER RECORD (SEARCH)

(Ref. FSM 7151.4)

Tract or
Survey No. _____

Cor.
No. R-05

T 19 S. R. 12 E.

R.D. Ft. Rock County Deschutes

NW Sec. 29

Merid. WMT

N.F. Deschutes State Oregon

CORNER DIAGRAM

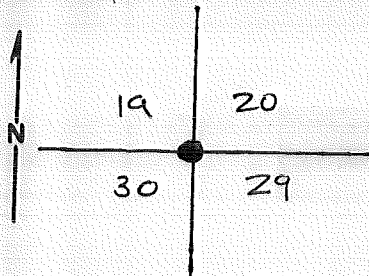

T19S R12E

PHOTO IDENTIFICATION DATA

Photo No. _____
Filed At _____
Object Ident. _____
Ident. By _____

Signature _____

7

PLANE COORDINATE POSITION DATA

State _____ Zone _____
X _____
Y _____
Estab. By _____
Agency _____

Signature _____

Title _____

Division _____

Headquarters _____

Date _____

William R. New

PLS

CS

SO

9/93

FS-7100-52 (3/68)

DESCRIBE CORNER MONUMENT FOUND

SF/NF

DESCRIBE BEARING TREES OR OTHER OFFICIAL ACCESSORIES FOUND

2

SW & SE BT's. Set corner by dist./dist. intersect. From the corner position the Original BT's are as follows:
A P. P. stump, 26" dia. S.58° W., 118 lks. (77.9 ft.) with bottom of blaze & chaining notch.
A P.P. stump, 24" dia. S.44° E., 24 lks. (15.8 ft.) with bottom of blaze & chaining notch. Both Stumps have been burned.
Remains of a P.P. stump in the NE BT's location.
No evidence of the NW BT.
Old location board on Rd. 220, S.76°E., 114 ft. from corner.

DESCRIBE CORNER LOCATION RELATIVE TO NEAR-BY FEATURES, ALSO HOW TO REACH CORNER

4

5

CORNER RECORD (PERPETUATION)

MONUMENT: DESCRIBE NEW MONUMENT SET, OR WORK DONE TO PRESERVE EXISTING MONUMENT

2 1/2" dia X 30" long steel pipe, surmounted by 2 1/2" Brass cap; 26" in the ground, surrounded by mound of stone. Penny @ base of pipe.

T. 195

519	520	R 12 E
530	529	
PLS 2396		
1993		

Steel fence post 3 ft. North

ACCESSORIES : DESCRIBE NEW BT'S WITNESS OBJECTS ETC. ESTABLISHED, OR WORK DONE TO PRESERVE EXISTING EVIDENCE

PP. 17 " dia. N 17° E 10.5 ft. mkd T195 R12E S20 B.T.

PP 18 " dia S 28° E 19.0 ft. mkd T195 R12E S29 B.T

PP 13 " dia S 27° W 7.1 ft. mkd T195 R12E S30 BT

PP 8 " dia N 75° W. 38.9 ft. mkd X B.T

Brass washer mkd PLS 2396 nailed between the B & T. in scribbing.
Mag Dec 19 1/2° E Staff compass brgs.

Work Done By W. Ham Title Land surveyor Date 9/1/93 State Registration No. or Agency 2396

Certified Cor. Record Prepared? Yes No Filed At: _____ Date _____

orig. 610 survey of 1880 : REMARKS by Melvum Moore & Campbell

set post for corner to Secs. 19, 20, 29 & 30 from which:

A Pine 30th diam. bears N 18° E 32 LKS dist. (21.1')

A " 10 " " " N 65° W 40 " " (26.4)

A " 29 " " " S 54° W 118 " " (77.9')

A " 22 " " " S 55° E 24 " " (15.8')

Index File No. T. R. M. Tract or Surv. No. Cor.

USDA-FOREST SERVICE

Index File No. 0567

CORNER RECORD (SEARCH)

(Ref. FSM 7151.4)

Tract or Survey No. _____ Cor. No. R-05

T 19 S. R. 12 E. R.D. Ft. Rock County Deschutes NW Sec. 29

Merid. WMT N.F. Deschutes State Oregon

CORNER DIAGRAM

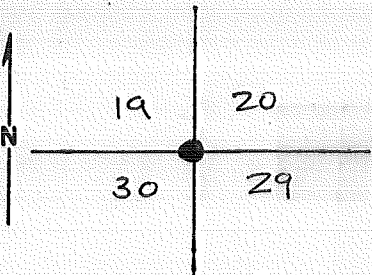

T19S R12E

PHOTO IDENTIFICATION DATA

Photo No. _____
 Filed At. _____
 Object Ident. _____
 Ident. By _____
 Signature _____

PLANE COORDINATE POSITION DATA

State _____ Zone _____
 X _____
 Y _____
 Estab. By _____
 Agency _____

DESCRIBE CORNER MONUMENT FOUND

SF/NF

DESCRIBE BEARING TREES OR OTHER OFFICIAL ACCESSORIES FOUND

SW & SE BT's. Set corner by dist./dist. intersect. From the corner position the Original BT's are as follows:
 A P. P. stump, 26" dia. S.58° W., 118 lks. (77.9 ft.) with bottom of blaze & chaining notch.
 A P.P. stump, 24" dia. S.44° E., 24 lks. (15.8 ft.) with bottom of blaze & chaining notch. Both Stumps have been burned.
 Remains of a P.P. stump in the NE BT's location.
 No evidence of the NW BT.
 Old location board on Rd. 220, S.76°E., 114 ft. from corner.

DESCRIBE CORNER LOCATION RELATIVE TO NEAR-BY FEATURES, ALSO HOW TO REACH CORNER

Signature William R. New Title PLS Division CS Headquarters SO Date 9/93 FS-7100-52 (3/68)

CORNER RECORD (PERPETUATION)

MONUMENT: DESCRIBE NEW MONUMENT SET, OR WORK DONE TO PRESERVE EXISTING MONUMENT

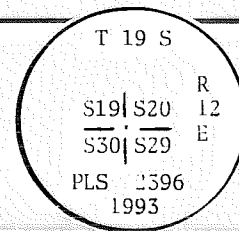

Set a 2½" dia. X 30" long steel pipe surmounted by a 2½" dia. brass cap; 26" in the ground, surrounded by a mound of stone. Penny at base of pipe. Steel post 3 ft. North.
 A P.P., 17" dia., N.17°E., 10.5 ft., mkd. T19S R12E S20 BT
 A P.P., 18" dia., S.28°E., 19.0 ft., mkd. T19S R12E S29 BT
 A P.P., 13" dia., S.27°W., 7.1 ft., mkd. T19S R12E S30 BT
 A P.P., 8" dia., N.75°W., 38.9 ft., mkd. X BT

RVE EXISTING EVIDENCE

A brass washer mkd. LS 2596 nailed between the B & T in the scribing. Bearings taken to center of the tree, distances to side center at the root crown.
 P.P. = Ponderosa Pine.

Work Done By Bill Ham Title PLS Date 9/93 State Registration No. 2398
 or Agency
 Certified Cor. Record Prepared? Yes No Filed At: Deschutes Co. Date 9/93

REMARKS

GLO Survey of 1880 by Meldrum, Moore & Campbell.
 Record - Set post for corner to Secs. 19, 20, 29 & 30 from which:
 A Pine 50 in diam. bears N.18° E. 52 lks. dist.
 A " 10 " " " N.65° W. 40 " "
 A " 24 " " " S.54° W. 118 " "
 A " 22 " " " S.55° E. 24 " "

Index File No. 0567 T. 19 R. 12 U.M.T. Tract or Surv. No. Cor. R-05
 GPO: 1986 O-439-095

Index
File No. _____

CORNER RECORD (SEARCH)

(Ref. FSM 7151.4)

Tract or Survey No. _____

Cor. No. R-05

T 195 R. 12E

R.D. Ft. Rock County Deschutes

Merid. Wil.

N.F. Deschutes State Ore

CORNER DIAGRAM

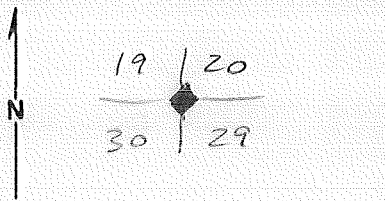

DESCRIBE CORNER MONUMENT FOUND

S.F.N.F.

DESCRIBE BEARING TREES OR OTHER OFFICIAL ACCESSORIES FOUND

SW & SE BT's set cor. by Dist/Dist
Intersect. From cor. orig. BTs are:
26" dia. P.P. Stump with chaining notch and
bottom of blaze. S 58° W 118 LKS (77.9 ft.)
24" dia. P.P. Stump with chaining notch & bottom of blaze.

PHOTO IDENTIFICATION DATA

Photo No. _____
Filed At _____
Object Ident. _____
Ident. By _____
Signature _____

DESCRIBE CORNER LOCATION RELATIVE TO NEAR-BY FEATURES, ALSO HOW TO REACH CORNER

S. 44° E. 24 LKS (15.8 ft.)
Loc. poster on rd 220 approx 114 ft. S, 76° E
Remains of a pine stump in NE BT location
No evidence of NW BT.

PLANE COORDINATE POSITION DATA

State _____ Zone _____
X _____
Y _____
Estab. By _____
Agency _____

Signature W Ham Title _____ Division _____ Headquarters _____ Date 9/1/75 FS-7100-52 (3/68)

CORNER RECORD (PERPETUATION)

MONUMENT: DESCRIBE NEW MONUMENT SET, OR WORK DONE TO PRESERVE EXISTING MONUMENT

2 1/2" dia x 30" long steel pipe, surmounted by 2 1/2" Brass cap; 26" in the ground, surrounded by mound of stone. Penny @ base of pipe.

T. 19 S
 S19 | S20 R
 S30 | S29 12
 PLS 2396 E
 1993

Steel fence post 3 ft. North

ACCESSORIES : DESCRIBE NEW BT'S WITNESS OBJECTS ETC. ESTABLISHED, OR WORK DONE TO PRESERVE EXISTING EVIDENCE

PP 17 " dia. N 17° E 10.5 ft. mkd T195 R12E S20 B.T.

PP 18 " dia S 28° E 19.0 ft. mkd T195 R12E S29 B.T

PP 13 " dia S 27° W 7.1 ft. mkd T195 R12E S30 BT

PP 8 " dia N 75° W 38.9 ft. mkd X B.T

Brass washer mkd PLS 2396 nailed between the B & T, in scribbing.
 mag DEC 19 1/2° E Staff compass brgs.

Work Done By W. Ham Title Land Surveyor Date 9/1/93 State Registration No. 2396 or Agency

Certified Cor. Record Prepared? Yes No Filed At: _____ Date _____

orig. GLO Survey of 1880 : REMARKS by Melvyn Moore & Campbell

Set post for corner to Secs. 19, 20, 29 & 30 from which:

A Pine 30 in diam.	bears	N 18° E	32 Lks	dist.	(21, 1')
A " 10 " "	"	N 65° W	40 "	"	(26, 4)
A " 24 " "	"	S 54° W	118 "	"	(77, 9')
A " 22 " "	"	S 55° E	24 "	"	(15, 8')

Index File No. T. R. M. Tract or Surv. No. Cor. 13

1. T 19S R 12E No. R-9 Cor. Sec. Mer. W State Oregon N.F. Deschutes Dist. Fort Rock

2. Corner Status

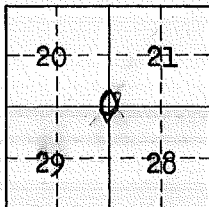

7. PHOTO IDENTIFICATION

Photo No. _____

Ident. By: _____

8. Plane Coordinate Position Data

State _____ Zone _____

X _____

Y _____

Est. By _____

Field Book No. _____

Where Filed _____

9. EVALUATION

Authentic _____

Needs Verif. _____ Manum. _____

Re-Est. _____ Survey _____

Land Status _____

3. Original Description _____ Vol. _____ Page _____ Where recorded _____

4. Description of Corner:

Cruiser's tag on old high stump .
Blaze on stump with scribing but scribing is
not legible.

5. Investigation Notes:

6. Signed _____ Title _____ Date _____

5680-2 (6/59)

T-9

1. T 19S R 12E No. T-9 Cor. 1/4 Mer. W State Oregon N. Deschutes Dist. Fort Rock

2. Corner Status

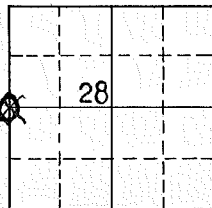

3. Original Description _____ Vol. _____ Page _____ Where recorded _____

4. Description of Corner:

Cruiser's tag on high stump of BT.

5. Investigation Notes:

7. PHOTO IDENTIFICATION

Photo No. _____

Ident. By: _____

8. Plane Coordinate Position Data

State _____ Zone _____

X _____

Y _____

Est. By _____

Field Book No. _____

Where Filed _____

9. EVALUATION

Authentic _____

Needs Verif. _____ Manum. _____

Re-Est. _____ Survey _____

Land Status _____

6. Signed _____ Title _____ Date _____